

Snow Closure Procedure



It is very rare that we close the school due to snow but if we do need to close we will send out a text message, post the information on our school Facebook and Twitter and put the information on our school website. If any children arrive at school, we will of course keep them and contact parents to arrange for them to safely return home.

If we did need to close during the school during the school day, then we ask you to follow the following procedure. Again, we would send out a text and inform parents as above. We would of course keep children until parents were able to collect them.

Full Closure During the School Day

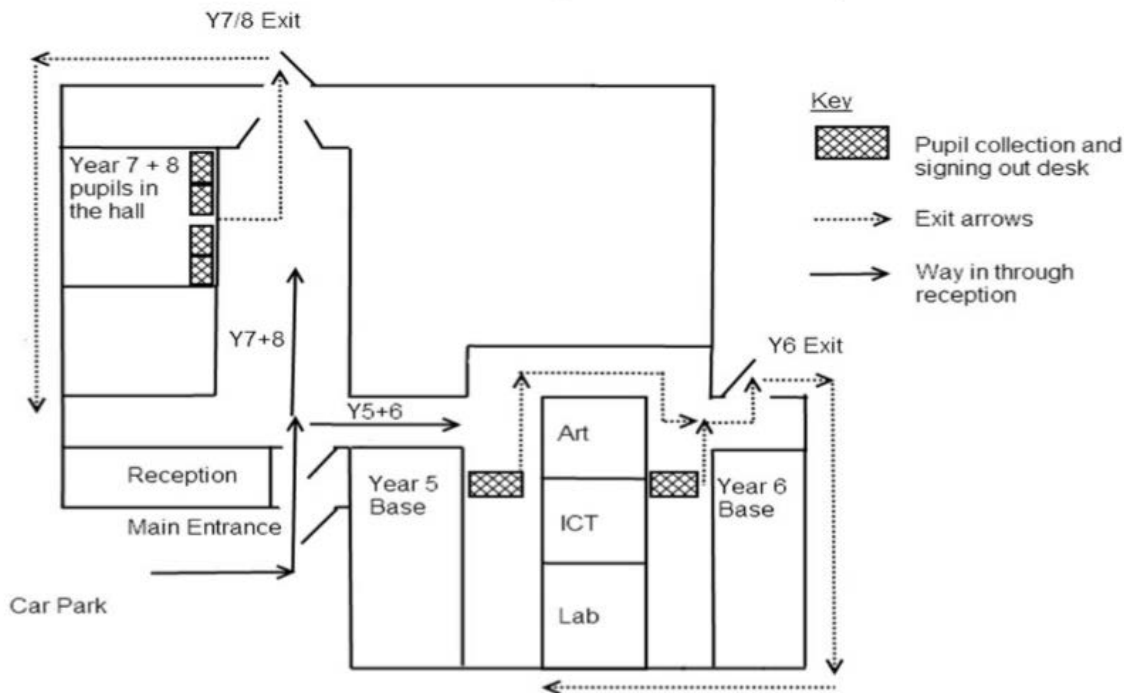

- All parents are to enter school through the main reception
- Parents of Y5 report to the Y5 base, giving the name of their child to staff on the Y5 collection point. Please wait for your child to be signed out at the desk and then leave the building via the Y6 cloakroom door to head round the right side of the building towards the car park.
- Parents of Y6 report to the Y6 base, giving the name of their child to staff on the Y6 collection point. Please wait for your child to be signed out at the desk and then leave the building via the Y6 cloakroom door to head round the right side of the building towards the car park.
- Parents of Y7 and Y8 are to report to the main hall, giving the name of their child to staff on the Y7/8 collection point. Please wait for your child to be signed out as you collect them from the desk and then leave the building via the Y7 cloakroom door, turning left around the building towards car park.
- If you're collecting children and their siblings from different year groups, please collect the youngest first, ensuring that each child is signed out from the relevant collection point.
- If children are to walk home themselves, parents must inform the school before their child is allowed to leave the school premises. Those pupils should be signed out from their year base collection points.